



BRID

User Manual

BRID

User Manual

Thank you for choosing Brid

By purchasing BRID, you made the wise decision to improve the quality of the air you breathe

Please read this manual before use
Please keep this manual in a safe place for future reference

MEET BRID & COMPONENTS	.04
QUICKSTART	.05
GENERAL SAFETY INFORMATION	.06
WARNINGS & CAUTIONS	.07
HOW TO SET UP	.08
OPERATING MODES	.09
CARE & MAINTENANCE	.10
HOW TO CLEAN/REPLACE THE NWF PRE-FILTER	.11
HOW TO CLEAN THE CERAMIC FILTERS	.12
TECHNICAL SPECIFICATIONS	.13
CO MODULE & APP	.14
FAQ	.15

MEET BRID

4

BRID is a modular air purifier that uses the exclusive multi-patented L.E.A.P. technology.

BRID literally vaporizes: VOC, Carbon Monoxide, NOx, organic odors, formaldehyde, bacteria, mold spores and more.

BRID has a modular and compact design that makes it the perfect solution for every indoor environment. By using the latest nanotechnology, BRID has set a new standard for air purification devices.

COMPONENTS

- 1. TOP MODULE
- 2. CERAMIC FILTER*
- 3. POWER MODULE*
- 4. BASE MODULE
- 5. NWF PRE-FILTER
- 6. PROTECTION GRILL
- 7. POWER CORD
- 8. SAFETY ROD

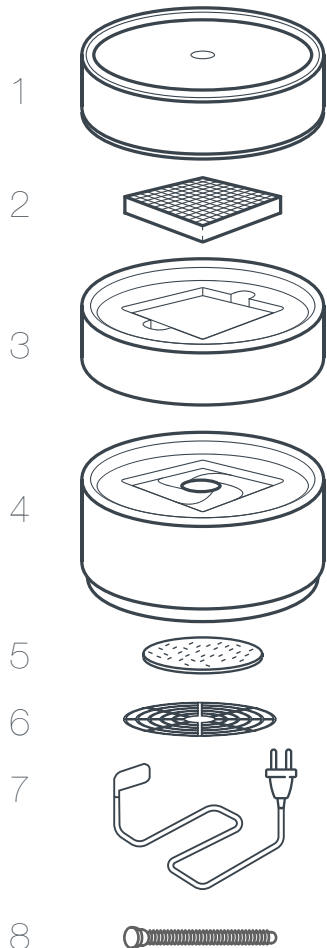

* According to your purchase, this component may be repeated (BRID XL, XXL)

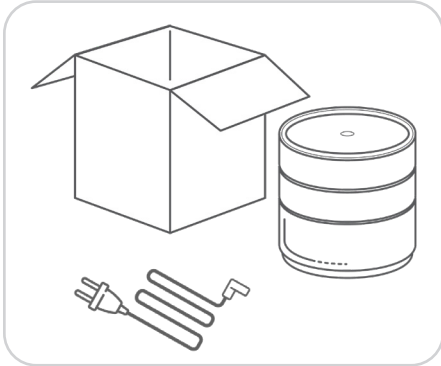

1. UNPACK BRID

Carefully extract BRID and all its components from the cardboard box. Take extra care when handling the ceramic filter/s.

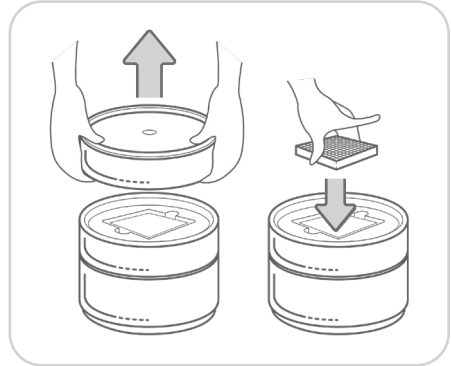

2. PLACE FILTER/S

Remove the top module and place the ceramic filter in the dedicated slot of the power module*. Put the top module back in place.

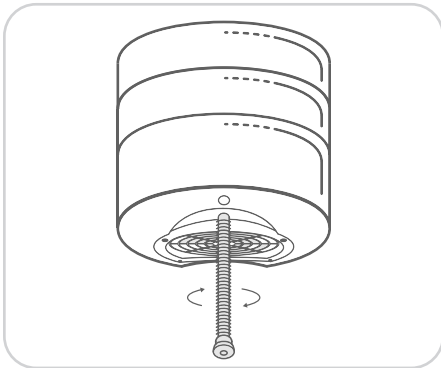

3. SAFETY ROD

You can use the provided safety rod to lock the different modules to the base. Screw the rod inserting it in the dedicated hole at the bottom of the device and tighten it all the way to the cap.

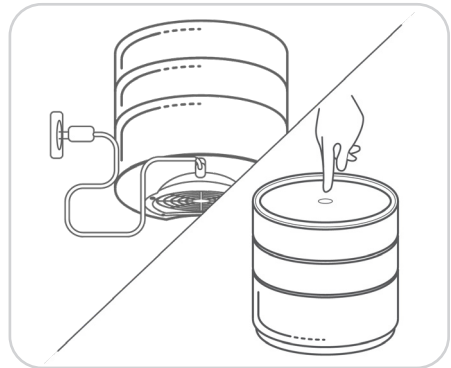

4. CONNECT THE POWER CORD

Insert the power cord into the slot located at the base of the product. Be sure to insert the plug completely into the socket. Press the power button. BRID is ON.

* This operation should be repeated for every power module

GENERAL SAFETY INFORMATION

6

BEFORE USING THE DEVICE, READ ALL INSTRUCTIONS AND CAUTIONARY WARNINGS IN THIS MANUAL.

When using an electrical appliance, basic precautions should always be taken, including the following:

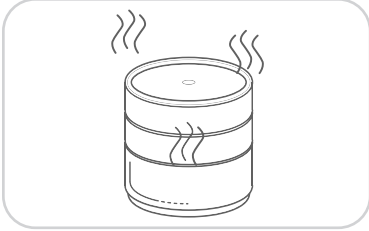

Stop using BRID if there's any irregularity, such as unusual sounds, smells or if it overheats.

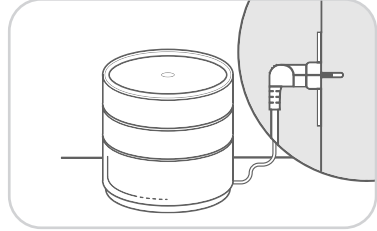

Make sure the cable is fully inserted into the socket. BRID is for indoor use only.

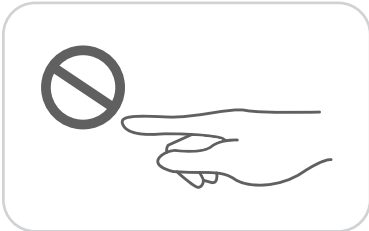

Do not insert foreign objects or your fingers inside the grill or moving parts. Please observe extreme caution when using the air purifier in close proximity to children.

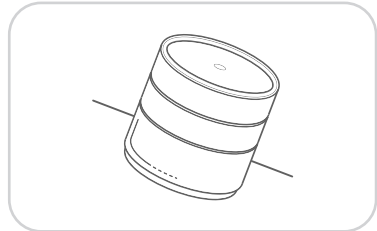

Do not use BRID on unstable surfaces or next to precarious objects. This may cause injuries if it falls over.

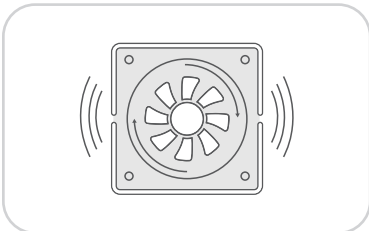

Turn BRID off if you hear abnormal sounds coming from the fan.

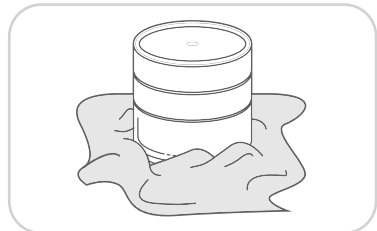

Do not obstruct BRID's fan located inside the base of the product. It is important not to block the airflow.
Do not place objects on or near the device and keep it away from water at all times!

WARNINGS

The following warnings indicate hazards with a medium to high level of risk which, if not avoided, could result in death or serious injury.

- Do not damage the power cord or plug
- Do not use if the power cord or plug becomes damaged, hot or loosely plugged into the socket
- Do not use on voltages over 220-240V or over the specified ratings for the socket or wiring appliances
- Do not handle the plug or the appliance with wet hands
- Make sure the plug is fully inserted into the base
- Stop using BRID and unplug it if there are any abnormalities or malfunctions
- Unplug from socket if not in use for long periods
- Regularly clean and remove the dust from the electric plug
- When unplugging from the socket, pull from the plug. The use of an extension cable is not recommended
- Never pull or jerk the plug out of the socket from a distance
- When cleaning, inspecting or moving the product, be sure to turn the power off and unplug
- Do not insert objects such as your fingers, or metal items into the air outlet, filters or openings inside the body of the device
- Do not disassemble, repair or alter the product
- Do not wet or run water over the product other than when cleaning the filters
- Do not use chlorine or acidic detergents on filters or anywhere near BRID
- Do not use in the following locations:
 - Unstable surfaces
 - Places where there might be leakage or use of oil or burnable gases
 - Places where there are corrosive gases or dust from metallic objects
 - Places with direct heat such as a radiator
- Do not wipe or clean with benzine, thinners or use harmful chemicals in or on BRID
- Do not allow pets near BRID or its power cord
- Do not obstruct the airflow with laundry, clothing or any other type of fabric

7

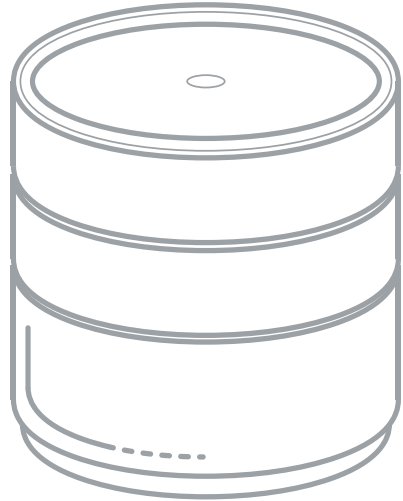

CAUTIONS

The following cautions indicate hazards with a low level of risk which, if not avoided, could result in minor or moderate injury or damage to property or furniture.

- Do not sit or lean on the product
- Do not lean on BRID when running
- When moving the product, do not put it on its side
- Once BRID is switched on, do not move it
- Always carry the appliance by its base
- Turn off the product before unplugging it
- Unplug from the socket when not in use for extended periods of time
- To avoid tripping hazards, safely coil the cable

HOW TO SET UP

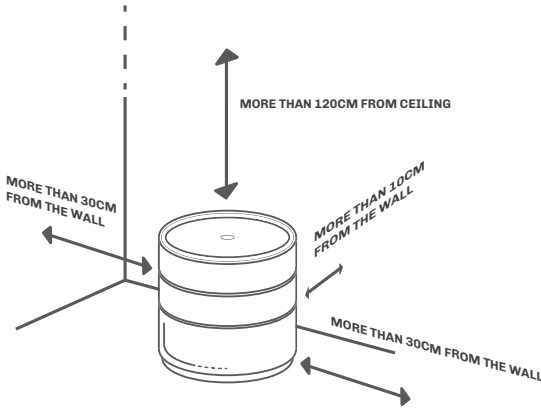

For maximum performance and reliability, place BRID at a suitable distance from the wall. Do not obstruct BRID's fan located at the base of the product. It is important not to block the airflow.

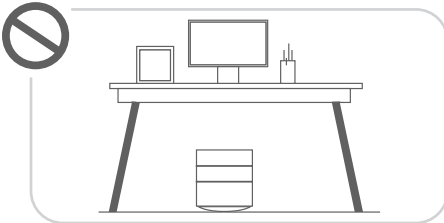

DO NOT PLACE UNDER A TABLE OR WHERE THE AIR OUTLET WILL BE BLOCKED

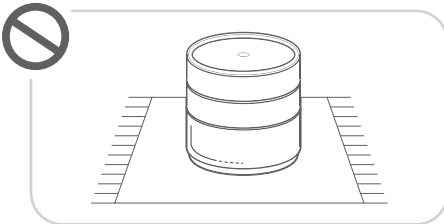

DO NOT PLACE ON UNSTABLE AND SOFT SURFACES LIKE CARPETS OR RUGS.

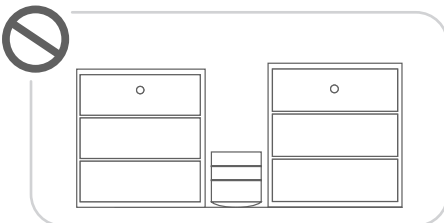

DO NOT PLACE BRID BETWEEN LARGE OBJECTS THAT COULD LIMIT THE AIRFLOW

OPERATING MODES

SWITCH BRID ON

Press the power button.

SWITCH MODE (SMART > BOOST > NIGHT)

Pressing the power button while BRID is on.

SWITCH BRID OFF

Press the power button for **2 seconds**.

MASTER RESET

Turn BRID on.

Turn BRID off.

Release the button, and wait 6 seconds.

Press the button, and keep it pressed until lights flash, release the power button.

DISABLE WIFI

Turn BRID on.

Turn BRID off.

Wait 6 seconds.

Keep the button pressed for approx. 10 seconds, then release the power button.

Lights flash 3 times

SMART MODE

BRID adjusts its cleaning cycles to the pollution level of the room thanks to its smart sensors. When the fan is not in motion BRID's light will turn on and off every 5 minutes to let you know the device is working properly.

BOOST MODE

BRID works at maximum speed for faster cleaning cycles.

NIGHT MODE

BRID slows down the fan and dims the light. You can turn the light completely off through BRID's App.

9



CARE AND MAINTENANCE

10

Switch off the device and remove the plug from the socket. Vacuum the dust from all over the product's surface. Gently wipe with a clean soft cloth.

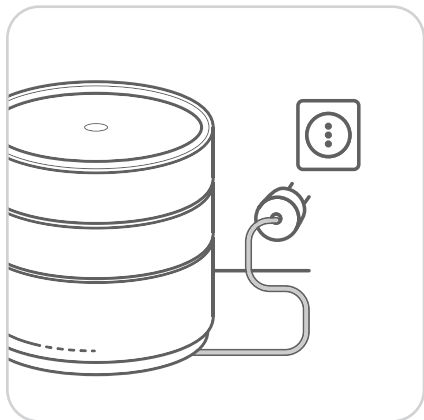

Be sure to remove the plug from the socket before starting the procedure

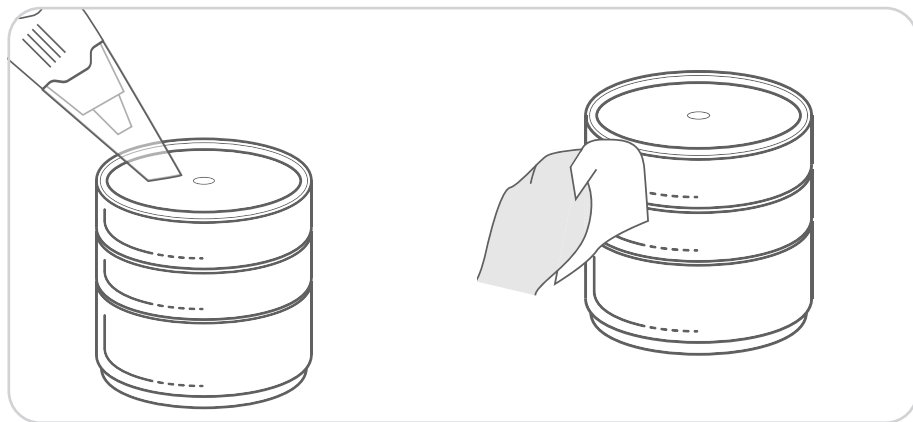

Vacuum the dust from all over the product's surface. Gently wipe with a clean soft cloth. **DO NOT USE** the following products: benzene, thinners, polishing powder or other solvents.

HOW TO CLEAN/REPLACE THE NWF PRE-FILTER

11

The NWF pre-filter should be cleaned/replaced according to the level of dust in the room, approximately once every 3 months or once every 2 months if living with pets.

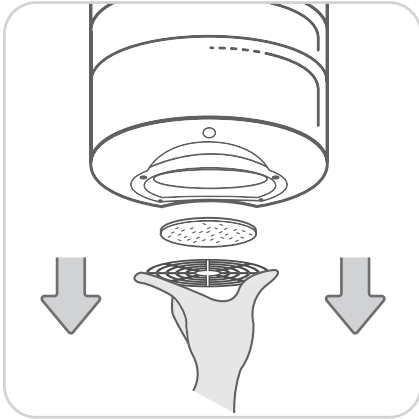

1

Remove the protective grill by pressing the 2 clips towards the centre.



2

Remove the NWF pre-filter. Vacuum clean or wash the prefilter under running water eliminating all the dust if present. If the NWF pre-filter is extremely dirty, dispose correctly and substitute it with a new/unused one.



3

Vacuum the protective grill eliminating all the dust until clean.

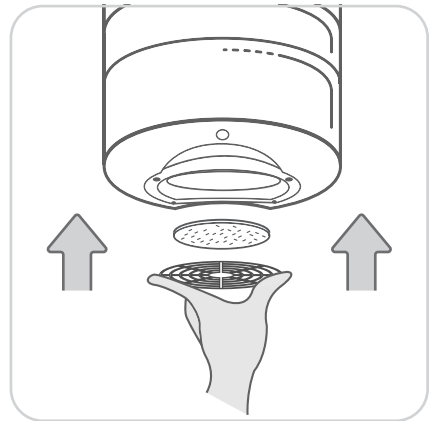

4

Insert the NWF pre-filter on the inside of the protective grill. Insert the protective grill into the slot positioned on the bottom of the purifier until it clicks in place.

HOW TO CLEAN THE CERAMIC FILTERS

For best results, clean the ceramic filters at least once every 4 months.

12

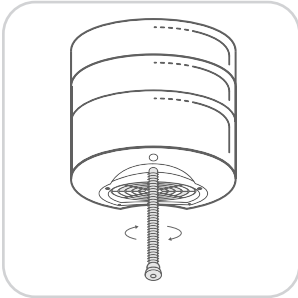

1
Unplug BRID and unscrew the safety rod if present.

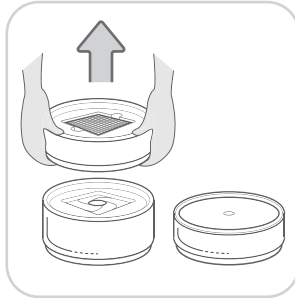

2
Gently remove the top unit and disassemble the remaining power filter modules.

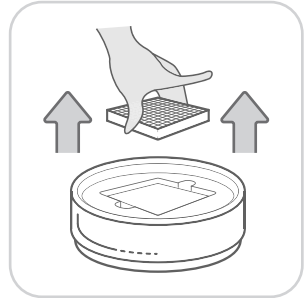

3
Safely remove the ceramic filter from the power filter module.

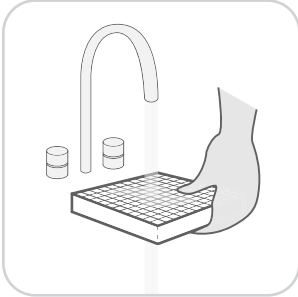

4
Wash the ceramic filter under warm running water, no soap needed. Let the filter dry for at least 12 hours*. Carefully reassemble every module.



5
Make sure that the module with the sticker is assembled directly on top of the base and that the ceramic filters are secured to their slots.

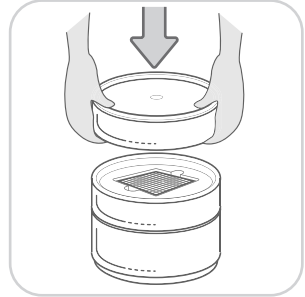

6
Place the top module as the final part. Screw the threaded rod back in place to lock the modules.

* Wet ceramic filters may have a distinctive smell. It will fade away after 12-24 hours.



BRID



BRID XL



BRID XXL

DIMENSIONS	25x25x24 cm 9,8x9,8x9,4 in	25x25x28 cm 9,8x9,8x11 in	25x25x33 cm 9,8x9,8x33 in
WEIGHT	3,5 kg (7,7 lb)	4,5 kg (9,9 lb)	5,5 kg (12,1 lb)
ENERGY CONSUMPTION*:	27 W	46 W	65 W
POWER SOURCE		110/220 V - 5.9 V D.C.	
NOISE LEVEL (BOOST)		50/55 Db	
NOISE LEVEL (SMART)		45/50 Db	
NOISE LEVEL (NIGHT)		30/35 Db	
FREQUENCY		50 GHz	
CLEANING FREQUENCY (PRE-FILTER)		every 2/4 months	
CLEANING FREQUENCY (CERAMIC FILTER)		every 6/8 months	

* In BOOST Mode

CO GUARDIAN MODULE

14

If you purchased the CO Guardian module, your BRID will come equipped with a Carbon Monoxide sensor and alarm. If the Carbon Monoxide concentration in your room exceeds a dangerous level BRID will warn you with a buzzing sound.

You can always monitor the Carbon Monoxide concentration through BRID's companion app.

BRID's CO Guardian module is an extremely useful tool but in no way substitutes a certified Carbon Monoxide detector.

DOWNLOAD THE APP

You can download BRID's app for free.

The app "BRID AIR" is compatible with iOS and Android. BRID's app is available from the App Store and Google Play.

Main features:

- Wi-Fi connectivity
- Pollution monitoring
- Real-time statistics
- Manual set-up



SET UP THE APP

Once you have downloaded the app, you should set up your Brid as part of your Home Network.

15

We call this procedure "pairing process", and it will allow the App to communicate with the Brid when you're at home.

Before diving into the step-by-step tutorial, please be sure the following points are satisfied:

- Your home network must be 2.4Ghz, Brid is not compatible yet with 5Ghz ones.
- Brid has a safety mechanism which is turning its WiFi off after couple of minutes. So if your Brid has been already turned off but never paired with your home network, you should perform a "Master Reset" as descibed at page 9 of this manual.
- The pairing process is slightly different between iOS and Android, so please refer to the right section depending on your mobile device.
- Sometimes, when we release a new firmware with major updates, a clean reboot of your Brid might be needed. In those cases, you will loose the pairing with your Brid, so you should repeat the pairing process once again.

PAIRING WITH IOS

- Perform a "Master Reset" as described on page 9 of this manual
- Open the "Home" app by Apple (if you don't have it on your phone, you can find it on the apple store)



Home

- from the "Home" app, follow the visual instructions to connect Brid to your home network.

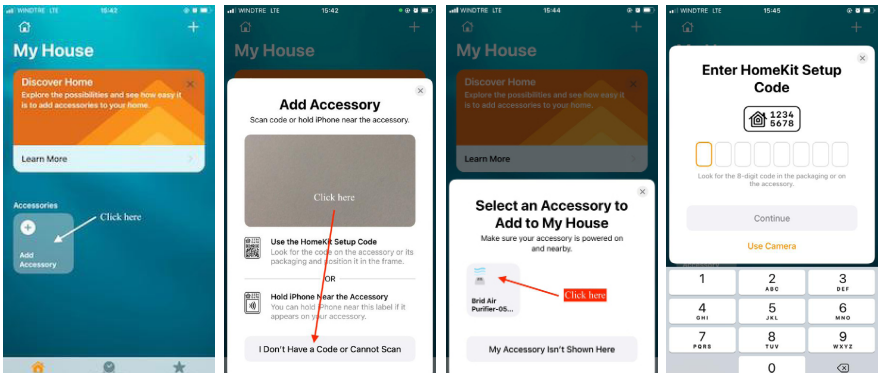

- Once you introduce the Provisioning Code, your Brid will be connected to your home network. You can now open the Brid App, and you will find your Brid listed and ready to be added to your dashboard, as shown in the following pictures.

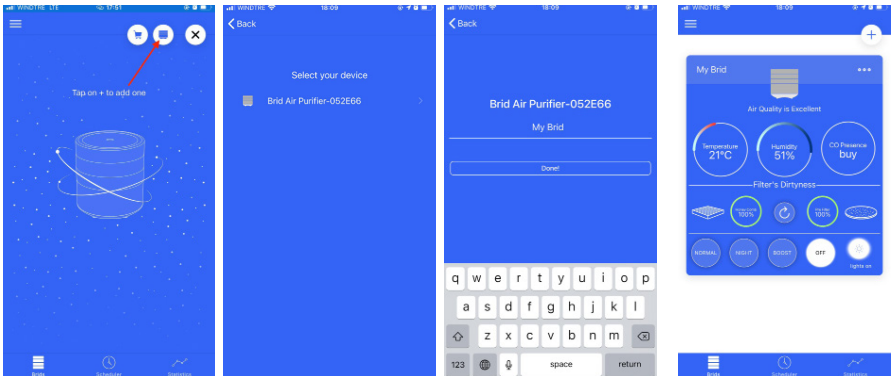

PAIRING WITH ANDROID

- Perform a "Master Reset" as described at page 9 of this manual
- Open the Brid App, and allow permissions for GPS and Network.
NOTE: without those permissions enabled, the App won't be able to scan your network properly!!
- Follow the instructions as shown in the following pictures:

17

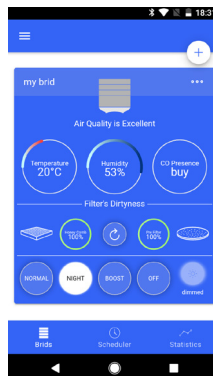
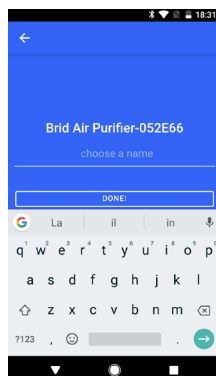
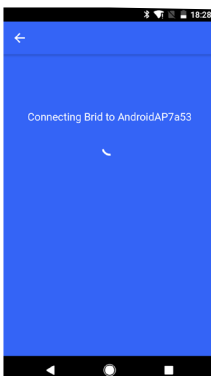
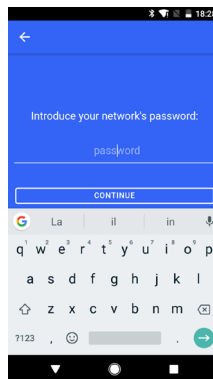
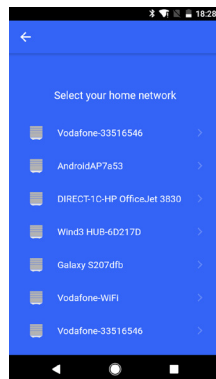
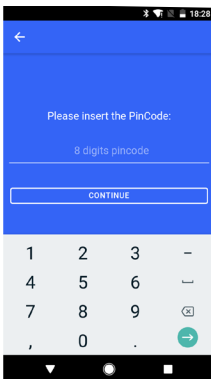
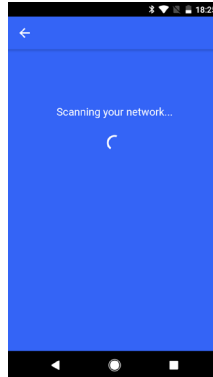
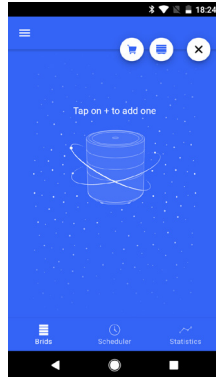
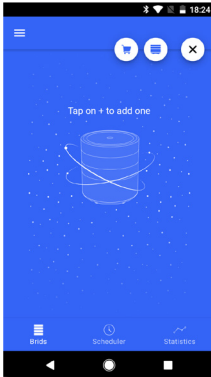

BRID DOESN'T TURN ON

- Is the power plug fully inserted into the base?
- Is the power plug fully inserted into the socket?
- Are the power modules connected correctly?
- Is there a power outage in your area?
- Is the power breaker on?

BRID DOESN'T BLOW AIR

- Did you remove the plastic wrapping from the internal components of BRID?
- Are the power modules connected correctly?
- Is the pre-filter dirty?
- Are you in Smart Mode? Even when not operating, BRID monitors the pollution levels in your environment

THE FAN MAKES A LOUD NOISE

- Are the filters obstructed in any way?
- Are you in boost mode?

HOW OFTEN SHOULD THE CERAMIC FILTERS BE CLEANED?

- The ceramic filters should be cleaned every 4 to 6 months
- It is recommended to clean the ceramic filters every 3 months or as often as needed if you smoke indoors or live with smokers and/or pets.

HOW OFTEN SHOULD THE PRE-FILTER BE CLEANED?

- The pre-filter should be cleaned according to the level of dust in the room, approximately every 3 months.

I CAN'T PAIR THE BRID'S APP TO THE DEVICE

- Master reset the device and follow the instructions as indicated on page 9
- Be sure that your router is working on the 2.4 GHz frequency band
- Wifi channels 12 and 13 are not supported

A BAD SMELL WON'T GO AWAY

- BRID can only remove organic odors
- You may need to wash the filters

